

Mono Bendable

One-piece implant with maximum accuracy

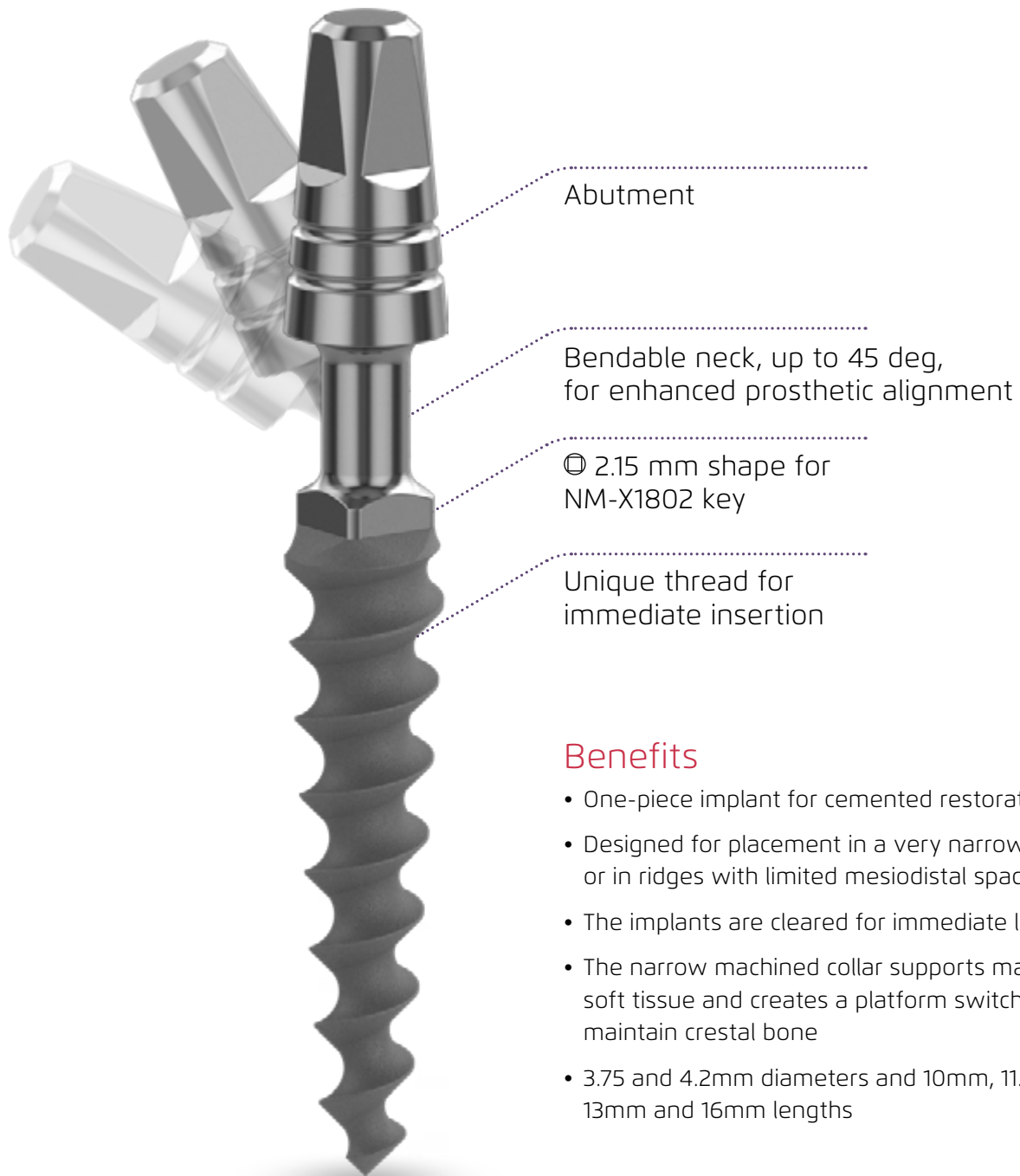

Abutment

Bendable neck, up to 45 deg,
for enhanced prosthetic alignment

© 2.15 mm shape for
NM-X1802 key

Unique thread for
immediate insertion

Benefits

- One-piece implant for cemented restorations
- Designed for placement in a very narrow ridge, or in ridges with limited mesiodistal space
- The implants are cleared for immediate loading
- The narrow machined collar supports marginal soft tissue and creates a platform switch to maintain crestal bone
- 3.75 and 4.2mm diameters and 10mm, 11.5mm, 13mm and 16mm lengths

Mono Bendable Implant

Surgical Drilling Protocol

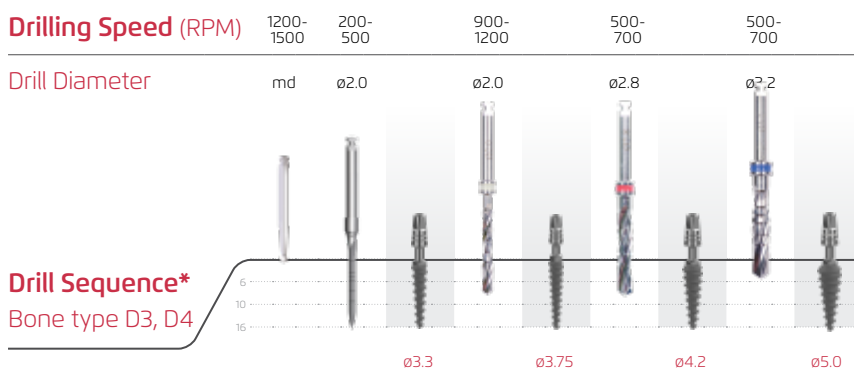
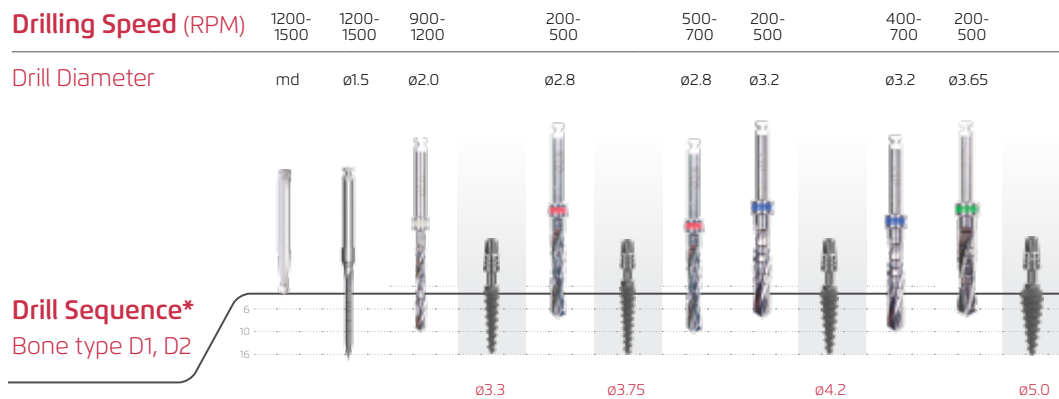

*The proposed procedure is only a recommendation and should not replace the doctor's judgment. The implants may be placed in immediate function when good primary stability (above 35 Ncm) has been achieved and with appropriate occlusal loading.

Mono Bendable Components

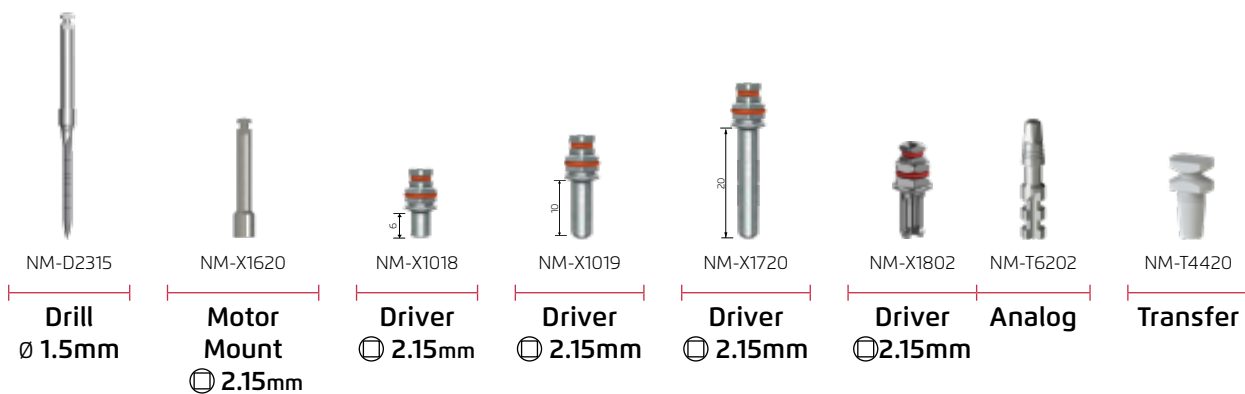

Mono Bendable Implant

Bendable MONO implants are specifically used in basal bone on upper and lower jaws and are designed for immediate prosthetic loading for bridges and bar connectors. The implants are one-piece implants having an RBM treated bone condensing thread, machined straight narrow collar and abutment. A square key section (patent pending) between the implants thread and collar enables direct insertion torque to the implant thread (using a special driver) thus bypassing the





insertion torque having been transferred through the collar when applied to the abutment key. The collar dimensions are designed to bend up to 45 deg when a bending torque is applied to the abutment. In appropriate clinical conditions MONO implants may be loaded immediately.

Material: Titanium (Ti6Al4V ELI)
Treatment: RBM

Features

- Attached abutment segment for immediate loading
- Bendable neck for prosthetic alignment
- Two most common diameters
- Unique thread for immediate load support

Technical Specifications

Implants	Ø D (mm)	Ø D1 (mm)	Ø D2 (mm)	L (mm)	Item
	3.3	1.8	1.8	10	NMBV3310
				11.5	NMBV3311
				13	NMBV3313
				16	NMBV3316
	3.75	1.9	1.8	6	NMBV3706
				8	NMBV3708
				10	NMBV3710*
				11.5	NMBV3711*
				13	NMBV3713*
				16	NMBV3716*
	4.2	1.9	1.8	6	NMBV4206
				8	NMBV4208
				10	NMBV4210*
				11.5	NMBV4211*
				13	NMBV4213*
				16	NMBV4216*
	5.0	1.9	1.8	8	NMBV5008
				10	NMBV5010
				11.5	NMBV5011
				13	NMBV5013
				16	NMBV5016

* Only CE Approved

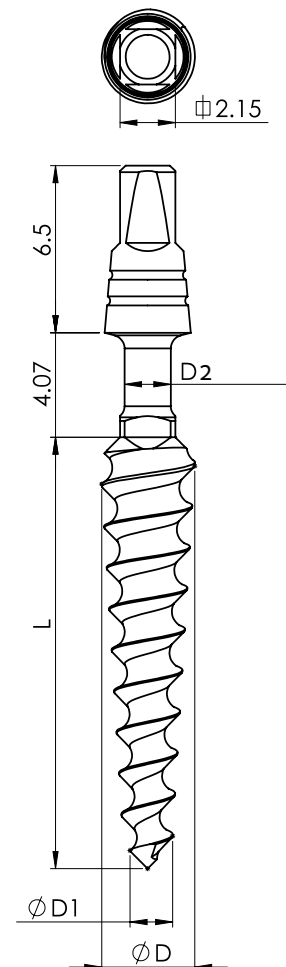

www.norismedical.com